



## Maintenance Guide

For the H.01L and Sm.Oil Oil / Water Interface Meters

---

This interface is designed to measure the thickness of floating product (L.N.A.P.L.). It will also detect and measure sinking layers of L.N.A.P.L.s.

This instrument has been designed and built to give years of reliable and accurate use.

Please follow the simple guidelines given in this booklet for the best performance from your unit.

### Signals indicate the following:

The continuous tone and light indicates product (hydrocarbon). Intermittent tone and light indicates water.

## General Hints

### Cold Weather

In cold weather condensation will form on the lens as it enters the well and contacts the warmer moist air in the well. This causes the unit to sound as product. To overcome this allow the probe to acclimatise in the well or lower the probe into the water, then take readings.

A dirty or scratched probe lens aggravates this problem.

### Removing The Probe

This requires two wrenches a 1/2"AF and 9/16"AF. When the knurled nut has been loosened the link may be still tight in the probe. Gently separate the link from the probe by hand. Care must be taken to avoid either breaking the wires while removing the probe or crimping the wire while replacing the probe.

### Do...

- Avoid sharp edged casing
- Avoid entanglement with other equipment in boreholes and wells.
- Clean and dry probe after use
- Rewind tape onto reel after each use

**Warranty is conditional upon adherence to these guide lines.**

### Do Not...

- Do not use to plumb borehole depths
- Do not use as guide to backfilling with sand etc. Instrument may get locked in sand.

### Remember to...

- CLEAN THE UNIT AFTER USE
- AVOID SCRATCHING THE LENS
- HANG THE UNIT ON THE CASING WHERE POSSIBLE, AND RUN THE TAPE OVER THE FRAME LEG. THIS PROTECTS THE TAPE AGAINST CUTS AND NICKS
- THIS IS A TOOL TO HELP YOU TO DO YOUR JOB WELL. TREAT IT PROPERLY AND IT WILL NOT LET YOU DOWN

IF YOU HAVE ANY OTHER QUESTIONS OR COMMENTS  
CALL 1-800-331-2032 OR YOUR SUPPLIER.

## Tips For Using The Oil/Water Interface Meter

### THE WAY IT WORKS

**IN AIR** the infrared emitter sends out an I/R beam inside a 45 degree prism.

The I/R beam reflects off the internal face of the prism to the opposite face, which then reflects the beam to the detector.

In this state the instrument is silent.

**IN FLUIDS** which are denser than air, the SNELL principle operates.

The I/R beam is not reflected internally, but exits the prism. The detector does not detect the I/R beam.

In this state the instrument emits a tone and the red light is on.

At the same time the two conductivity probes are testing for conductivity.

If the fluid does not conduct electricity, the sound tone and light are solid (product) If the fluid does conduct electricity, the tone is intermittent (water).

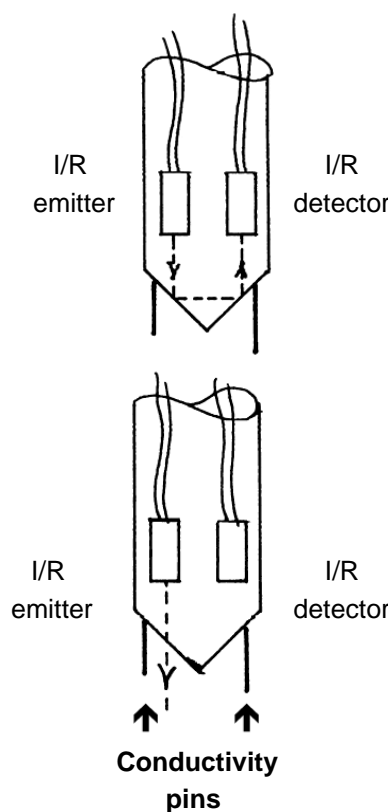

### Care of Reel

Remove electronic front panel before wash down.

Reel may be cleaned with the following:

**Aliphatics:** Hexane, Heptane, White Kerosene, Mineral Spirits

**Alcohols:** Methyl, Isopropyl, Isobutyl  
1 + 3 Denatured Alcohol

**Halogenated** Freons TF + TE

**Hydrocarbons:**

**Others:** Soap solution Naptha Alconox 10%, Fantastic<sup>®</sup>, Windex<sup>®</sup>, Joy<sup>®</sup>, Top Job<sup>®</sup>, Mr. Clean<sup>®</sup>, Formula 409<sup>®</sup>.

<sup>®</sup> Registered Trade Marks

## Care of Tape and Probe

Tape and Probe may be cleaned and de-greased with the following:

**Alcohols:** Hexane, Heptane

**Aliphatics:** Hexane, Heptane, White Kerosene, Mineral Spirits

**Halogenated** Fully Halogenated Freon

**Hydrocarbons:**

**Others:** Soap Solution, Naptha Alconox 10%, Joy detergent<sup>®</sup> 10%, Lestoil<sup>®</sup>

### Do Not clean with abrasives.

The Probe lens is made from an Amorphous Thermoplastic, highly resistant to many chemicals, however, contact with the following should be avoided or approached with caution:

#### Chloroform I.I.2. Cresol, Iodine, Oleum, Resorcinol

Partially Halogenated Hydrocarbons such as Methylene Chloride, Phenol (saturated solution) should be approached with care. If exposure to any of the above causes damage to the instrument

## English

### INSTRUCTIONS

PRESS BUTTON = METER ON FOR 4 MINUTES

GREEN LIGHT ON = METER ACTIVE - BATTERY GOOD

GREEN LIGHT OFF = METER OFF OR BATTERY NO GOOD

### INTERFACE METER

GROUND METER WITH LEAD PROVIDED

OIL STEADY LIGHTS AND BUZZER TONE

TAKE MEASUREMENTS GOING THROUGH THE OIL INTO THE WATER, THEN BACK FROM THE WATER INTO THE OIL - REPEAT TO GET CONSTANT READING

### AFTER USE

REMOVE EXCESS MOISTURE

CLEAN PROBE AND TAPE WITH SOAP AND WATER

- DO NOT USE ABRASIVES OR SOLVENTS •
- PROTECT AND MAINTAIN POLISHED PROBE TIP FOR TOTAL WASHDOWN - REMOVE ELECTRONIC PANEL FROM REEL. DO NOT WASH ELECTRONICS. DRY REEL AND REPLACE ELECTRONIC PANEL.

## Spanish

### INSTRUCCIONES

OPRIMA EL BOTON = MEDIDOR EN MARCHA DURANTE 4 MINUTOS  
LUZ VERDE ENCENDIDA = MEDIDOR EN MARCHA - BATERIA EN BUEN ESTADO  
LUZ VERDE APAGADA = MEDIDOR DETENIDO - BATERIA AGOTADA

### MEDIDOR DE INTERFAZ

PONGA EL MEDIDOR A TIERRA CON EL CONDUCTOR PROVISTO  
PETROLEO = LUCES Y ALARMA SONORA PERMANENTES  
AGUA = LUCES Y ALARMA SONORA INTERMITENTES  
TOME LAS MEDIDAS PASANDO DEL PETROLEO AL AGUA, LUEGO DEL AGUA AL PETROLEO - REPITA PARA OBTENER LECTURAS CONSTANTES.

### DESPUES DEL USO

ELIMINAR EL EXCESO DE HUMEDAD  
LIMPIAR LA SONDA Y CINTA CON AGUA JABONOSA  
**\* NO USAR ABRASIVOS NI SOLVENTES \***  
PROTEGER Y MANTENER LIMPIA LA PUNTA DE LA SONDA

PARA LIMPIEZA TOTAL - SACAR EL PANEL ELECTRONICO DEL CARRETE. NO LAVE LOS DISPOSITIVOS ELECTRONICOS. SECAR EL CARRETE Y VOLVER A COLOCAR EL PANEL ELECTRONICO.

## French

### INSTRUCTIONS

APPUYER SUR LE BOUTON = APPAREIL DE MESURE EN MARCHÉ PENDANT 4 MINUTES.  
TÉMOIN VERT ALLUMÉ = APPAREIL DE MESURE EN MARCHÉ - PILE EN BON ÉTAT.  
TÉMOIN VERT ÉTEINT = APPAREIL À L'ARRÊT OU PILE MAUVAISE.

### APPAREIL DE MESURE-INTERFACE

METTRE L'APPAREIL À LA TERRE À L'AIDE DU CONDUCTEUR FOURNI.  
PÉTROLE = TÉMOIN ET AVERTISSEUR CONTINUELLEMENT ALLUMÉS.  
EAU = TÉMOIN ET AVERTISSEUR ALLUMÉS PAR INTERMITTENCE.  
PRENDRE DES MESURES EN PASSANT DU PÉTROLE À L'EAU, PUIS DE L'EAU AU PÉTROLE. RÉPÉTER POUR OBTENIR UNE LECTURE UNIFORME.

## **APRÈS USAGE**

ENLEVER L'EXCÈS D'HUMIDITÉ.

NETTOYER LA SONDE ET LE RUBAN AVEC UNE SOLUTION D'EAU SAVONNEUSE.

**\* NE PAS UTILISER DE SOLVANT NI DE PRODUIT ABRASIF. \***

PROTÉGER ET GARDER LA POINTE DE LA SONDE BIEN PROPRE.

POUR UN NETTOYAGE TOTAL - ENLEVER LE PANNEAU ÉLECTRONIQUE DU DÉVIDOIR. NE PAS NETTOYER LES ÉLÉMENTS ÉLECTRONIQUES. SÉCHER LE DÉVIDOIR ET REMETTRE LE PANNEAU ÉLECTRONIQUE.

## **German**

### **BEDIENUNGSANLEITUNG**

KNOPF DRÜCKEN = MESSGERÄT IST 4 MINUTEN AN

GRÜNES LICHT AN = MESSGERÄT AKTIV - BATTERIE GUT

GRÜNES LICHT AUS = MESSGERÄT AUS ODER SCHLECHTE BATTERIE

### **SCHNITTSTELLEN-MESSER**

ERDSCHLUSS-MESSGERÄT MIT MITGELIEFERTEM ANSCHLUSSDRAHT.

Ö L = ANHALTENDES AUFLEUCHTEN DER LAMPEN UND SUMMERTON

WASSER = INTERMITTIERENDES AUFLEUCHTEN DER LAMPEN UND

SUMMERTON

NEHMEN SIE MESSUNGEN VOR, INDEM SIE DURCHS ÖL INS WASSER STOSSEN, DANN ZURÜCK VOM WASSER INS ÖL. UM KONSTANTE ABLESUNGEN ZU ERZIELEN, MÜSSEN SIE DIESES VERFAHREN WIEDERHOLEN.

### **NACH GEBRAUCH**

ÜBERSCHÜSSIGE FEUCHTIGKEIT ENTFERNEN.

MESS-SONDE UND BAND MIT SEIFE UND WASSER SÄUBERN.

**\* KEINE SCHEUER-ODER LÖSUNGSMITTEL ANWENDEN \***

DIE POLIERTE SONDENPRÜFSPITZE MUSS GESCHÜTZT UND GEGEWARTET WERDEN.

ZUR KOMPLETTEN WASHUNG MUSS DIE ELEKTRONIKTAFEL VON DER SPULE ABMONTIERT WERDEN. NICHT DIE ELEKTRONIK WASCHEN! DIE SPULE TROCKNEN UND DIE ELEKTRONIKTAFEL WIEDER ANMONTIEREN.

## **Probe Electronics**

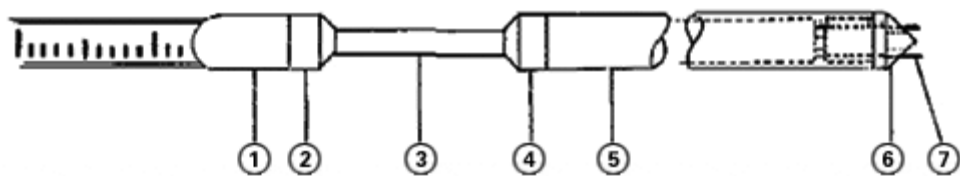

- |           |                      |              |                                    |
|-----------|----------------------|--------------|------------------------------------|
| 1 0100-41 | Tape Connector       | 5 0100-35/43 | Probe Body                         |
| 2 0100-34 | Link/Tape Connector  | 6 0100-38    | 1/F Lens.WLM Tip.<br>(WLM)-36(1/F) |
| 3 0100-42 | Link                 | 7 0100-39    | Conductivity Pins                  |
| 4 0100-40 | Link/Probe Connector | 8 0100-45/44 | Reel Electronics                   |

**Note:** Items 1 to 8 are servicable only by supplier.

### Reel Electronics

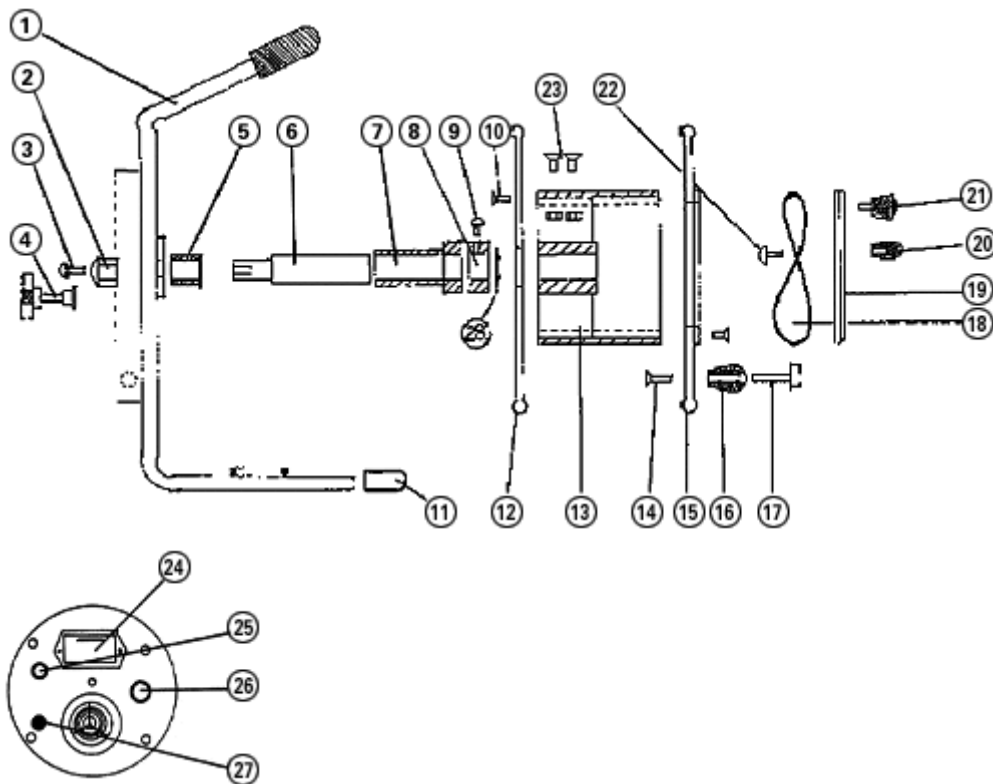

- |             |             |               |                     |
|-------------|-------------|---------------|---------------------|
| 1 01001A1B  | Frame       | 15 0100-3     | Front Plate         |
| 2 0100-9    | Nut         | 16 0100-5     | Cranking Handle     |
| 3 0100-23   | Screw       | 17 0100-11    | Spindle             |
| 4 0100-6/24 | Brake       | 18 0100-18    | O Ring              |
| 5 0100-18   | Spacer      | 19 0100-56    | Electric Disk       |
| 6 0100-8    | Shaft       | 20 0100-54    | Disk Handle         |
| 7 0100-13   | Bearing     | 21 0100-55/68 | Disk Retaining Knob |
| 8 0100-15   | Ground Ring | 22 0100-71    | Screw               |

<b>9</b>	0100-62	Screw	<b>23</b>	0100-59/60	Tape Screws
<b>10</b>	0100-20	Screw	<b>24</b>	0100-53	Battery Holder
<b>11</b>	0100-7	Frame Boot	<b>25</b>	0100-48/49	Battery L.E.D.
<b>12</b>	0100-2	Rear Plate	<b>26</b>	0100-46/47	Oil/Water L.E.D.
<b>13</b>	0100-4	Hub	<b>27</b>	0100-50/51	On/Off Button
<b>14</b>	0100-12	Screw	<b>28</b>	0100-14	Bearing Retainer

---

[Home Page](#)   [Close Window](#)   [Print This Page](#)